

**ART. 109**

Elle F.F.  
Female L

CODICE	A	B	C				
10918	G1/8	7	20,0			10	100
10914	G1/4	8	25,5			13	50
10938	G3/8	10	29,0			17	25
10912	G1/2	11	35,0			20	10
10934	G3/4	16	36,0			25	5
10901	G1'	19	44,0			30	5

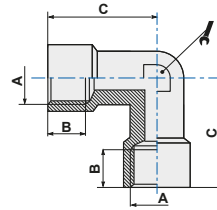

**ART. 110**

Elle M.F.  
Male-Female L

CODICE	A	A1	B	B1	C	D		
110M5	M5	M5	4		11,0	11,5	9	100
11018	G1/8	G1/8	7	8	20,0	19,0	10	50
11014	G1/4	G1/4	8	11	25,5	24,0	13	50
11038	G3/8	G3/8	10	11,5	29,0	26,5	17	25
11012	G1/2	G1/2	11	14	35,0	31,5	20	20
11034	G3/4	G3/4	16	16	35,0	34,5	25	10
11001	G1'	G1'	19	16	44,0	51,0	30	5
11014F18M	G1/8	G1/4	8	8	25,5	23,0	13	50

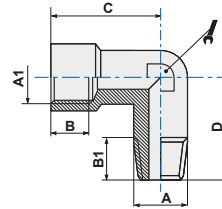

**ART. 111**

T F.F.F.  
Female T

CODICE	A	B	C	D		
11118	G1/8	7	20,0	40	10	50
11114	G1/4	8	25,5	51	13	25
11138	G3/8	10	29,0	58	17	10
11112	G1/2	11	35,0	70	20	10
11134	G3/4	16	31,0	73	25	5
11101	G1'	19	49,5	90	30	5

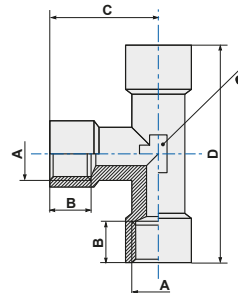

**ART. 112**

T F.M.F.  
Centre male T

CODICE	A	B	B1	C	D		
11218	G1/8	7	8,0	19,0	40	10	50
11214	G1/4	8	11,0	24,0	51	13	25
11238	G3/8	10	13,6	26,5	58	17	25
11212	G1/2	11	15,5	31,5	72	20	10
11234	G3/4	16	15,0	31,0	73	25	5
11201	G1'	19	16,0	38,0	90	30	5

