

ART. 02

Diritto femmina
Straight female adaptor

CODICE	ØD	G	ØC	ØB	H	L		
020418	4	1/8	3	12	6,5	26,5	9	50
020414	4	1/4	3	17	10	29,5	9	50
020618	6	1/8	5	12	6,5	28,3	11	50
020614	6	1/4	5	17	10	31,3	11	50
020818	8	1/8	7	12	6,5	28,5	13	50
020814	8	1/4	7	17	10	32,5	13	50

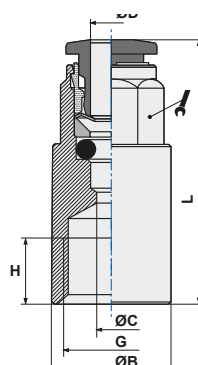

ART. 03

Diritto innestabile
Straight connector

CODICE	ØD	ØD1	ØB	ØC	L		
030400	4	4	3	9	32		50
030600	6	6	5	11	36,1		50
030800	8	8	7	13	38		50
031000	10	10	9	16	42,3		50
031200	12	12	11	19	45,8		25
031400	14	14	13	21	48,9		25

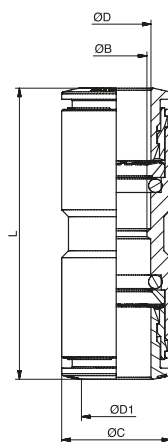

ART. 03F

Diritto innestabile filettato
Threaded connector

CODICE	ØD	ØC	M	L		
03F0400	4	3	11x1	32		50
03F0600	6	5	14x1	36,1		50
03F0800	8	7	16x1	38		50
03F1000	10	9	18x1	42,3		50
03F1200	12	11	22x1	45,8		25
03F1400	14	13	24x1	47,5		25

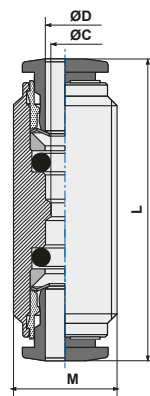

ART. 04

Gomito innestabile
L connector

CODICE	ØD	ØC	ØB	L		
040400	4	3	10	19		50
040600	6	5	11	20,6		50
040800	8	7	13	23		50
041000	10	8	16	26,4		50
041200	12	10	19	28,9		25
041400	14	12	21	31,5		25

